

2470/3  
GFSE

Sportanlage  
2474  
SPO

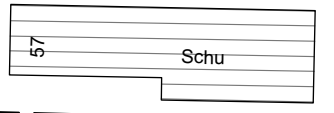

Oberriexinger Straße

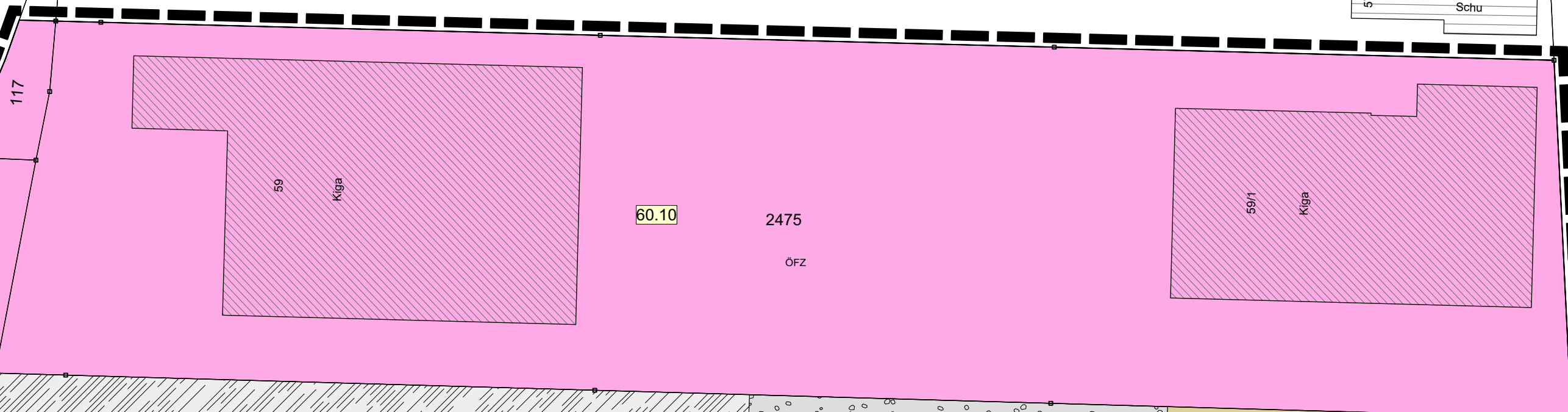

60.10

2475  
ÖFZ

59/1  
Kiga

3383/1  
ANL

117

2233

21.42

2482  
A

60.23

37.10

116/6  
WEG

3380/18  
ANL

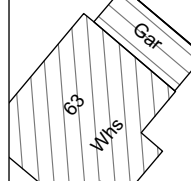

3380/16

2484

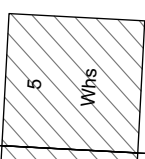

Gar

WBF

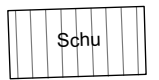

2483  
A

2485  
GR

3380/15

2486

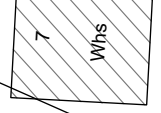

2487  
GR

2488

Kreis: Ludwigsburg  
Stadt: Sachsenheim  
Gemarkung: Großsachsenheim

Projekt: 2615  
Maßstab 1:500

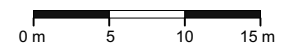

**GRÜNORDNUNGSPLAN**  
**Bestands- und Konfliktplan**  
**"Schule und Sportzentrum 2. Erweiterung"**

Datum  
27.07.2021

K M B

